

RUBENs

NEEDLE-VALVES PN100

with internal threads

House and chest hot-forged in one piece

MATERIAL SPECIFICATION:

Body: CW617N

Stem: CW617N

Packing: Molded graphite

Handwheel: Aluminium, Red lacquered

RSK. NR	DN	G
462 00 19	8	1/4
462 00 27	10	3/8
462 00 35	15	1/2

Working Pressure: Max 100 Bar at +20 °C

Operating Temperature: Max 185 °C

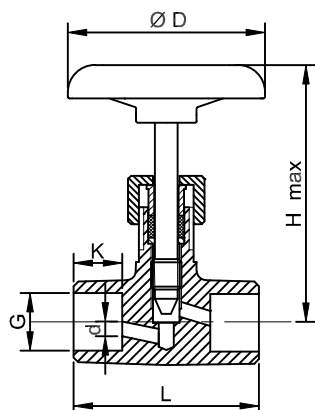

Size.		K	d	L	D	H max	Weight kg	Kv. values
DN	G							
8	1/4	14	5	48	65	80	0,30	0,42
10	3/8	16	5	54	65	80	0,30	0,48
15	1/2	17	5	56	65	80	0,34	0,54

- The valve can be supplied with: Locked boxnut.
- Area of use: As shut-off valve for steam, gases, and liquids
- Certificate: Material certificate DIN50049. 2.2 (specified when ordering)
- The products fall under AFS2016:1 Paragraph 8 and do not need to be CE marked.

Rubens
VERKSTAD AB

Njuravägen 11, SE-289 43 Broby
Tel. +46 44 40178
Email. info@rubensverkstad.se
www.rubensverkstad.se