

RUBENs

Pressure gauge valve PN400

Internal thread with checking flange

The valves are of forged steel construction

MATERIAL SPECIFICATION:

Stainless steel

Body: W.nr 1.4404

Stem: W.nr 1.4460

Packing: Molded graphite

Handwheel: Aluminium, Red lacquered

| RSK. NR | DN | G |
|-----------|----|-----|
| 462 32 00 | 8 | 1/4 |
| 462 32 01 | 10 | 3/8 |
| 462 32 02 | 15 | 1/2 |



| | | | | | |
|----------|-----|-----|-----|-----|-----|
| Pressure | 400 | 160 | 125 | 20 | bar |
| Temp | 20 | 125 | 200 | 300 | C° |

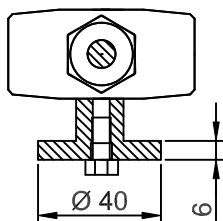
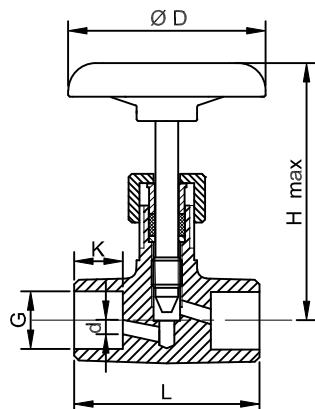

| Size. | | K | d | L | D | H max | Weight kg |
|-------|-----|----|---|----|----|-------|-----------|
| DN | G | | | | | | |
| 8 | 1/4 | 14 | 5 | 60 | 65 | 85 | 0,49 |
| 10 | 3/8 | 15 | 5 | 60 | 65 | 85 | 0,47 |
| 15 | 1/2 | 16 | 5 | 60 | 65 | 85 | 0,43 |

- All valves are tested before delivery.
- The valve can be supplied with: Locked boxnut, Handle of 1.4404.
- Area of use: as shut-off and control valve where high pressures and temperatures occur. The valves are intended for water, steam, oils and most common acids and alkalis.
- Certificate: Material certificate DIN50049. 2.2 (specified when ordering)
- The products fall under AFS2016:1 Paragraph 8 and do not need to be CE marked.

Rubens
VERKSTAD AB

Njuravägen 11, SE-289 43 Broby
Tel. +46 44 40178
Email. info@rubensverkstad.se
www.rubensverkstad.se